

King Henrys Walk, Islington, N1

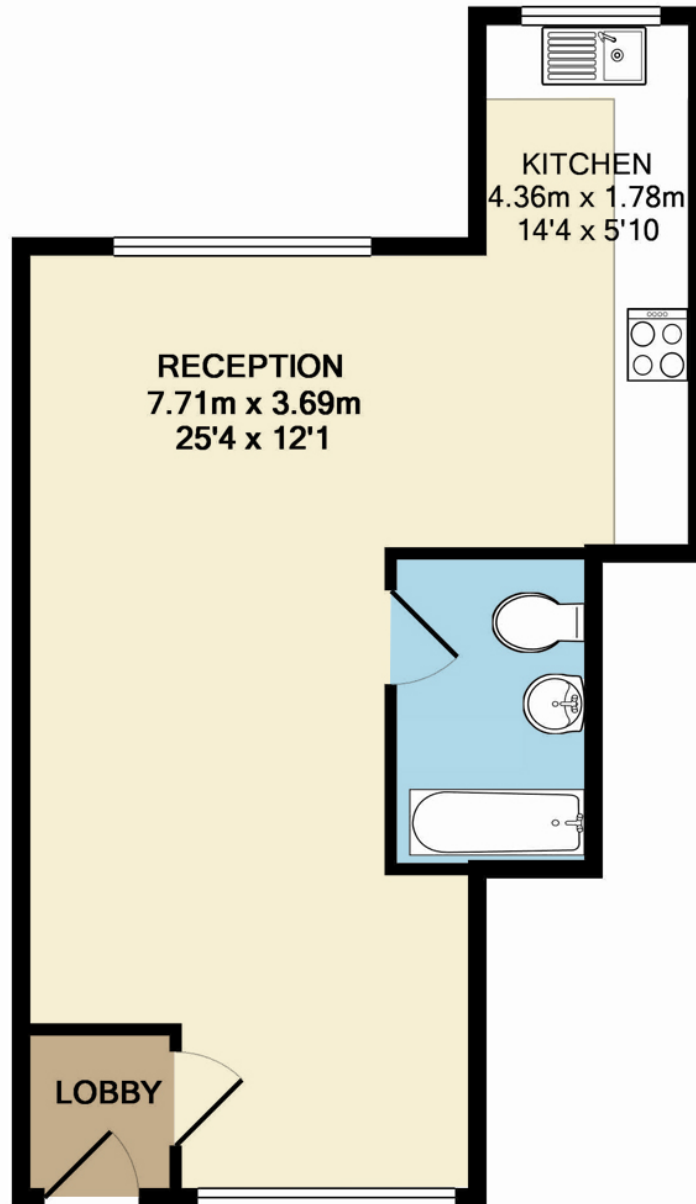

Benefiting from stylish finishes, this charming studio flat comprises reception room/ bedroom, semi-separate kitchen, bathroom. Situated on the ground floor, the period conversion is ideally located within easy reach of Canonbury or Dalston Kingsland/ Dalston Junction station. The vast array of shops and local amenities along Kingsland Road is only a short stroll away.

Price £200,000 Leasehold



King Henry's Walk, N1

Flat B - Ground Floor

Gross Internal Area: approx. 358 sq ft (33.3 sq m)

KeyAGENT LTD Floor Plans are produced and provided for illustration purposes only. Whilst every attempt has been made to ensure the plan is accurate and presents the property in the best way, measurements of doors, windows and rooms are approximate and no responsibility is taken for any error, omission or mis-statement. To find out more about KeyAGENT please visit www.keyagent.co.uk
(Tel: 0845 475 4165)
Made with Metropix ©2010

Energy Efficiency Rating		Current	Potential
Very energy efficient - lower running costs			
(92-100)	A		
(81-91)	B		
(69-80)	C		
(55-68)	D	72	76
(39-54)	E		
(21-38)	F		
(1-20)	G		
Not energy efficient - higher running costs			
England & Wales		EU Directive 2002/91/EC	

Environmental Impact (CO ₂) Rating		Current	Potential
Very environmentally friendly - lower CO ₂ emissions			
(92-100)	A		
(81-91)	B		
(69-80)	C		
(55-68)	D	69	72
(39-54)	E		
(21-38)	F		
(1-20)	G		
Not environmentally friendly - higher CO ₂ emissions			
England & Wales		EU Directive 2002/91/EC	